

NOTE:
 ALL 2x4 WALLS ARE DRAWN 3 1/2" THICK
 ALL 2x6 WALLS ARE DRAWN 5 1/2" THICK
 ALL DIMENSIONS ARE TO EDGE OF STUDS
 ALL EXTERIOR WALLS ARE 2x6 STUDS

NOTE:
 ALL STAIRS AND STEPS SHALL
 HAVE A MIN. 10" TREAD AND
 A MAX. RISE OF 7 3/4"

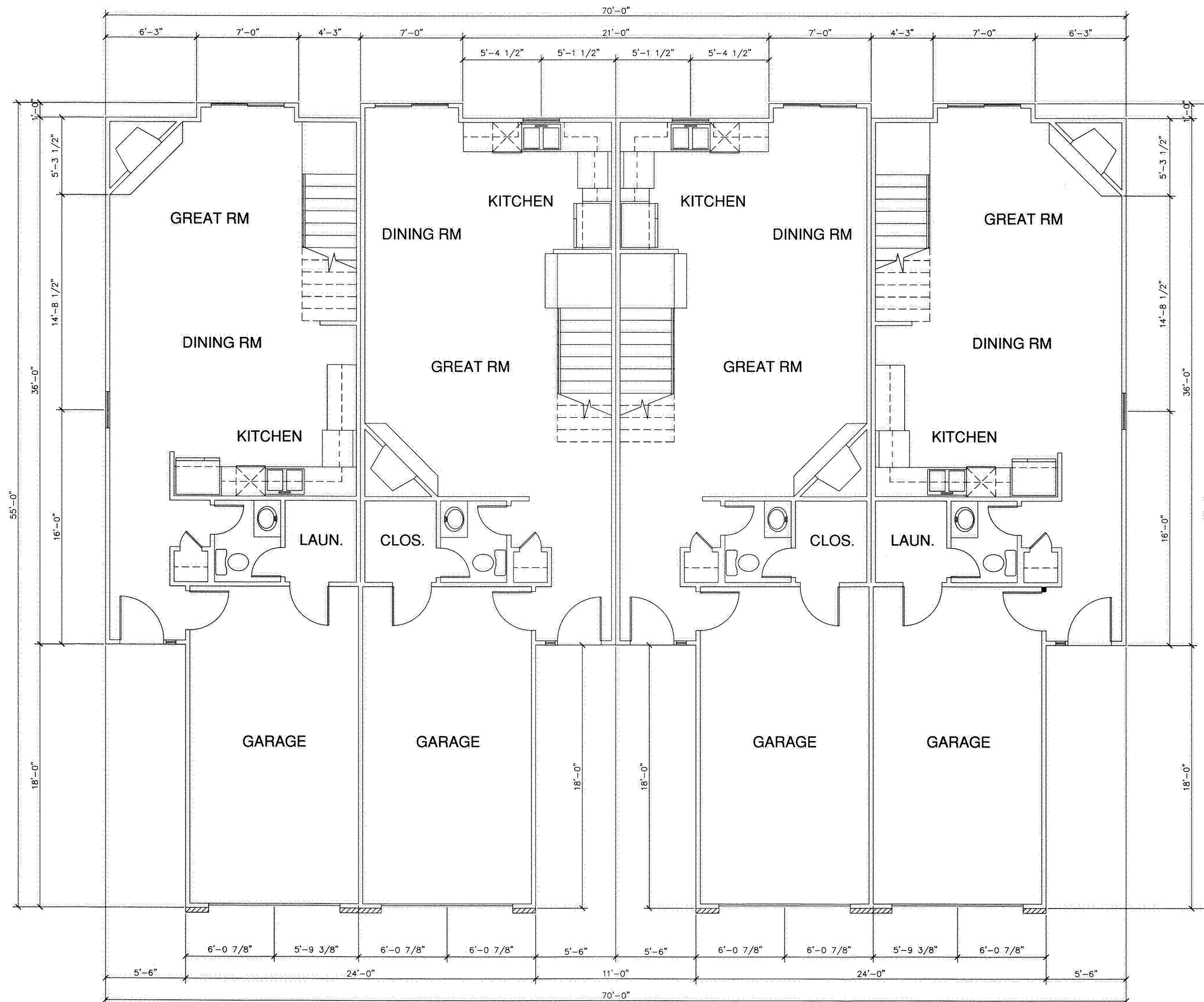

FIRST FLOOR PLAN 06042F1
 SCALE: 1/4" = 1'-0" 3,412 SQ FT